

ROTISSERIE MasterFlame GAS MF975.6G.SS or 975.6G.LUX

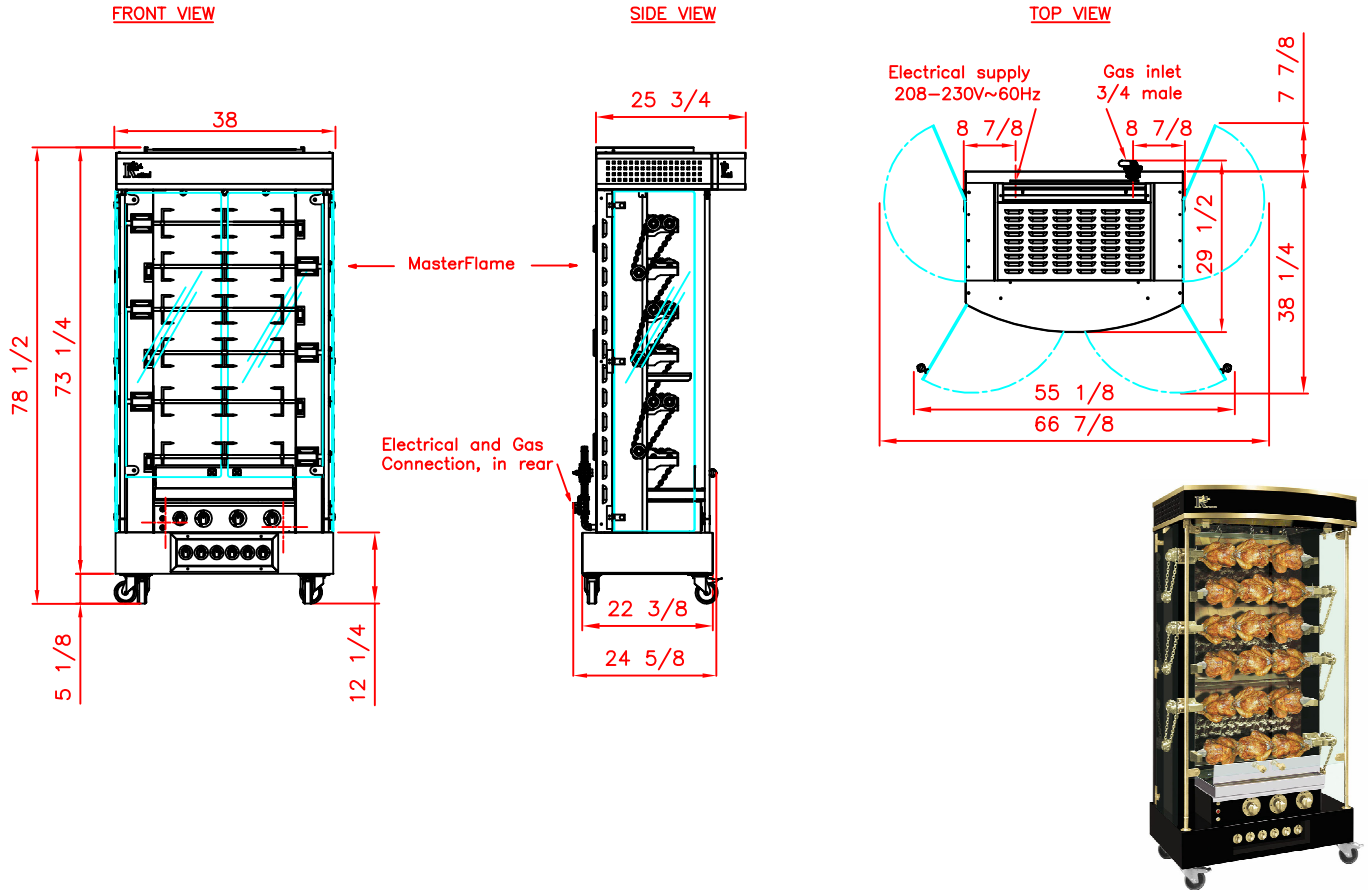

SPECIFICATIONS

Capacity: 12/18 poultries, Weight: 715 Lbs

All stainless steel with brass or chrome for rotisserie ref: MF975.6G.SS

Full body porcelain enamel with brass or chrome for rotisserie ref: MF975.6G.LUX

6 adjustable spits + alternative system of vertical spits with 3 hooks integrated

Securit glass protection with stop spits opening.

4 casters, 2 with brakes.

Electrical supply: 230Volts 1 phase+neutral+earth (208-230V~60Hz), 2,5 Amps , wire length 6'

Electric power 0,59 kW made up of:

_7 motors of 40 W,

_8 ventilators of 20 W, 1 halogen lamp of 150 W

Natural gas power: 82000 BTU/h.

OPTIONS: Enamel specific color ref: COUL 1, alternative engine ref: AM20.

ACCESSORIES: Spits, prongs, spit mover, gas lighter, rack and trays.

All this information are the property of Rotisol. Reproduction partial or in totality are prohibited without authority prior written of compagny Rotisol.

Scale: 1/33

Rotisol

November 2018