

OVEN/BASKETS ROTISSERIES STAR-CLEAN FORCED AIR AND STEAM REF.: SC5.520

FRONT VIEW

SIDE VIEW

TOP VIEW

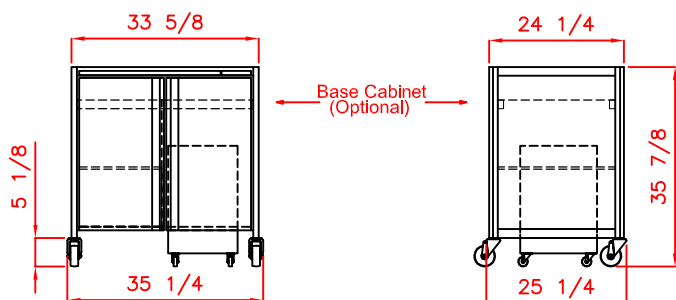
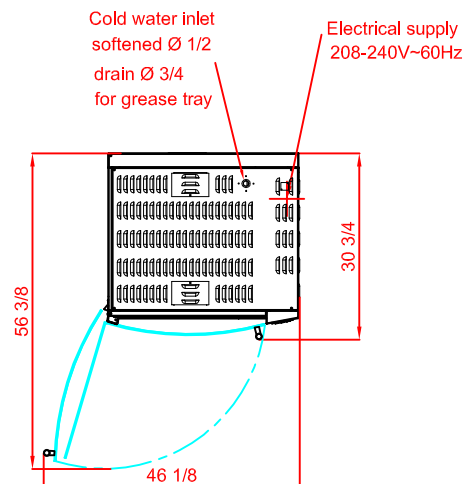
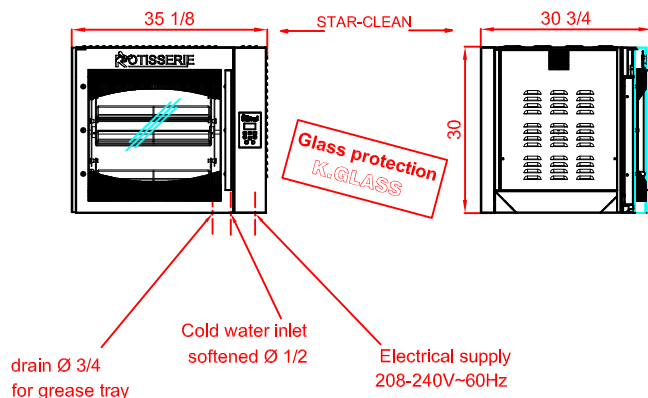

"K.GLASS" protection

Manufacturing:

The "K.GLASS" is a layer product manufactured on line, at high temperature, at oven output, where there fines metal particles are spread by pyrolysis on float clear surface, forming in that way an integrated layer to the door surface part. This layer is made with precious metals which give to the glass door quality of very low emissions, then a high resistance to the thermal radiance.

SPECIFICATIONS

Weight: 275Lbs, Capacity of poulties: 15/20, Number of baskets: 5.

Stainless presentation inside with central axis, support and removable baskets.

Entirely insulated. Régulation of the température by convection cooking.

Digital control of the température and time. Alarm at end of cooking cycle. Washing cycle.

1 front face glass door (anti-burns K.Glass) fitted on removable silicon joint.

Safety glass and screen-printed double glazed curved to one side ref. GLBS5520

Internal lighting by halogen lamp protected by glass cover.

high pressure shower ref. DOUCH

Power supply Volts 3 Phases + Earth (208-240V~60Hz) **Electrical power 6,15 kW; 18 Amps** , wire lenght: 6'

Provide extraction hood of a flow of 885 to 1180 cu ft/min with speed variator

OPTIONS AND ACCESSORIES: base cabinet with 2 doors, shelves and a pull out shelf ref. SC5.52MPE, brake wheel base ref. SC5.52PR

water softener filter ref. BRITA.2, façade color ref. COUL, grease tray ref. BG, baskets small pieces ref. BALRC520AS,

vegetables tray ref. PDSC520, bags high t° fat ref. SAC

All this information are the property of Rotisol. Reproduction partial or in totality are prohibited without authority prior written of compagny Rotisol.